

LED MINI STRIP

Mini Strip Light Fixture

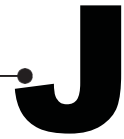

The LED Mini Strip fixtures are designed as a replacement for traditional 4FT 32W fluorescent T8 tubes. The single strip runs at an economic max 22W.



DIMENSIONS

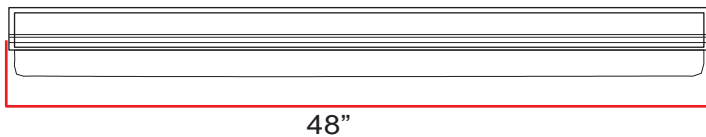
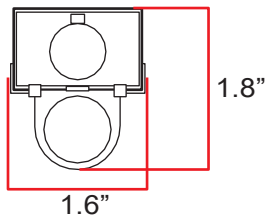

CERTIFICATIONS



FEATURES

- Simple and secure installation
- End to end mounting and wiring
- Seamless surface mounting application
- Linkable to 8FT strip fixture
- Diffused lighting distribution
- Minimize labor and recycling costs
- Acrylic drop lens that deliver low glare
- 80% more energy saving compared to traditional lamps
- 5 Year Manufacturer's Warranty

COMMON TECHNICAL DATA

Color Temperature	3000K to 5000K
CRI	>80
Operation Temperature	-20°C to 50°C
Lumen efficiency	140 LPW
Input Voltage	AC100-277V
Frequency	50-60Hz
Power Supply Efficiency	90%
Rated Life	50,000 hrs.
Power Factor	More than 0.98
LED Type	SMT 2835

WARRANTY

This product has a warranty for a period of 5 years from the date of purchase. The warranty is invalid in the case of improper installation, tampering, or removal of the Q.C. date label. Installation in an improper working environment or installation not according to the current edition of the National Electric Code also invalidates the warranty. Should this product fail during the warranty period, it will be replaced free of charge, subject to correct installation and return of the faulty unit. James® does not accept responsibility for any installation costs associated with the replacement of this product. This warranty is in addition to the statutory rights in the country of purchase. James® reserves the right to alter specifications without prior notice.

LED MINI STRIP

Mini Strip Light Fixture

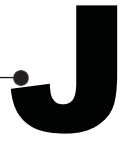

PRODUCT SPECIFICATION

Model Number	Length (FT)	Wattage	Color	Lumens	Input Voltage
ZY-SP4FT22W BNZ	4FT	22W	4000K	3140 lm	100-277 VAC
ZY-SP4FT22W BNZ	4FT	22W	5000K	3180 lm	100-277 VAC

ORDERING GUIDE

ZY	SP	4FT	22W	BNZ	4000K/5000K
Company Code	Housing Type	Length	Wattage	Non-Dimmable	CCT

MOUNTING OPTIONS

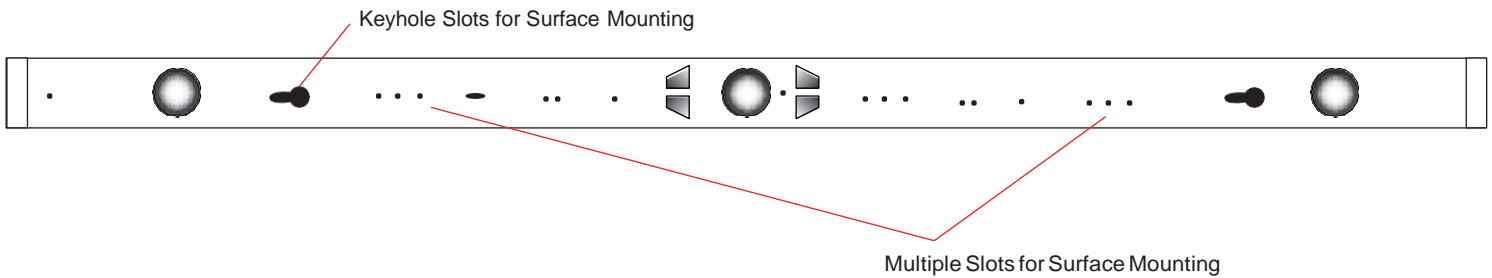

ELECTRICAL CONNECTION

